



INSTALLATION INSTRUCTIONS FOR 05+ TACOMA MOLLE BED RACK, KIT AP-308337

	NOTICE Read instructions completely before installing this product. Refer back to the instructions frequently during installation.		CAUTION Flying Object Hazard. Fluid Splash Hazard. Wear safety glasses at all times when working on vehicle.
WARNING: Cancer and Reproductive Harm - www.P65Warnings.ca.gov			

1. Using a T55 Torx bit remove the two front bed bolts.



AP-308401

2. Using the supplied 3/8 hardware, bolt the mounting feet to the bottom of the molle panel as shown. Do not fully tighten the bolts yet.



3. Remove the (2) factory M6 mounting bolts as shown from the header bar or accessory bar.

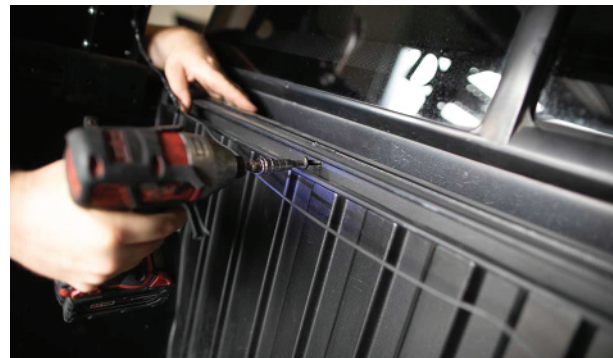

4. Align the molle panel as shown in the bed. In order to rotate the molle panel into place it may be necessary to temporarily remove one of the factory tie down points on the sides of the bed. After the molle panel is against the front of the bed reinstall the factory tie down point if applicable.

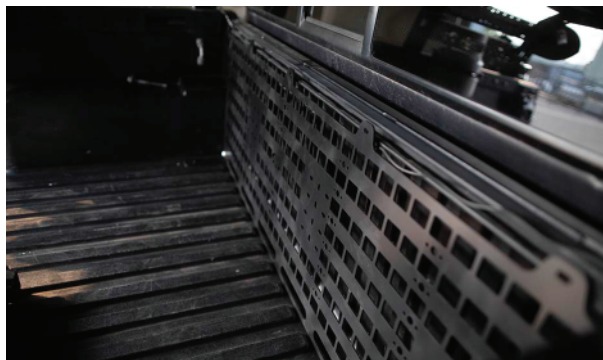

5. Using the supplied M6 hardware and spacers bolt the top of the molle panel to the (2) empty holes in the front of the bed.



6. To set the height of the mounting feet, first align the holes in the mounting feet with the holes used for mounting the bed. Start to screw the bed mounting bolts into the bed. Once the bed mounting bolts are started make sure the bottom of the mounting feet are flat against the bed. Tighten the (2) 3/8 bolts used to attach the mounting feet to the molle panel.



7. Remove the upper M6 mounting bolts that were attaching the molle panel to the front of the bed. Next remove the remaining factory M6 mounting bolts that hold the header panel or accessory bar onto the front of the bed. It may be necessary to remove the bed mounting bolts and slide the molle panel rearward so you can get to the remaining factory mounting bolts.





8. Install the supplied M6 mounting bolts and spacers into the holes in the front of the bed as shown. If you have an accessory bar, the molle panel can be mounted on either the front or the back of the bar as shown below. If you have a header bar we recommend that you mount the molle panel in front of the header bar as shown.



Suggested Mounting with Factory Header Bar

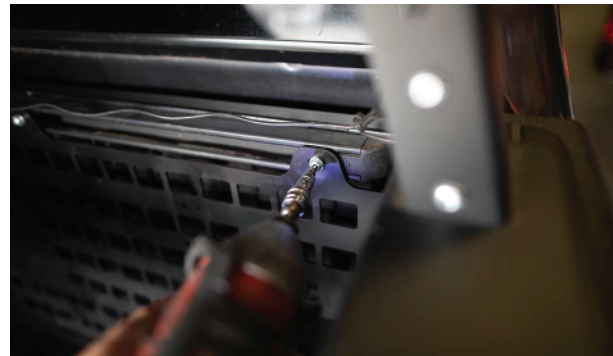

Suggested Mounting with Factory Accessory Bar

9. Install and torque the bed mounting bolts to secure the mounting feet.