

# Installation Guide

## Front Upper Shock Bushing

Suits : Landcruiser IFS 11/07 – on.  
: GRJ200 UZJ200 VDJ200 URJ202.

(Always refer to the current catalogue for complete application listings).

N.B. This install guide should be used in conjunction with the workshop manual.

### Note: 1

**Note:**  
Discard OE upper  
rubber bush and  
washer.

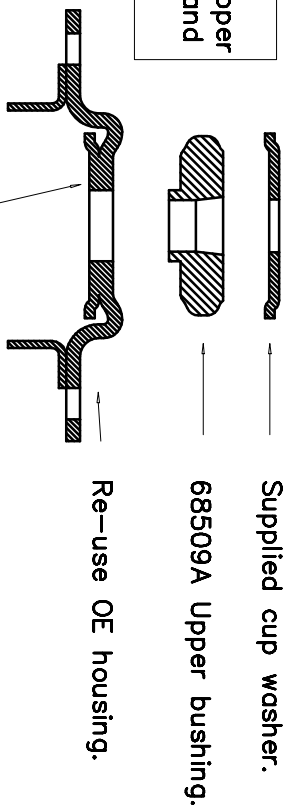

**Please note:** The lower OE rubber bush, if still bonded in position will need to be removed. The mating surface will also need to be cleaned of any remaining rubber and glue deposits.

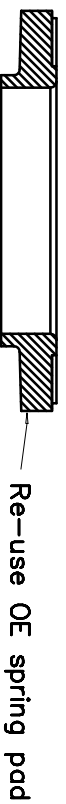

**Note:**  
Discard OE lower  
rubber bush and  
washer.

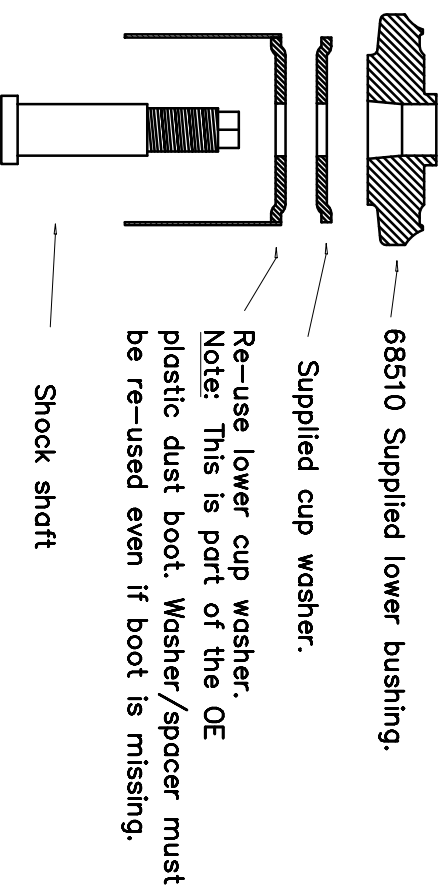

N.B. It is recommended that a licenced workshop or trades person carry out the above procedure and that workshop manual and relevant safety procedures are followed in addition to the above.