

# ROUGH COUNTRY

## SUSPENSION SYSTEMS®

### ROUGH COUNTRY 12 VOLT OUTDOOR LIGHT

Thank you for choosing Rough Country for all your vehicle needs.

Please read instructions before beginning installation. Check the kit hardware against the kit contents shown below. Be sure you have all needed parts and know where they go.

If question exist, please call us @1-800-222-7023. We will be happy to answer any questions concerning this product. Check all fasteners for proper torque. Check to ensure for adequate clearance between all components. Periodically check all hardware for tightness.

**NOTE: Take care using this LED light assembly in windy or hazardous weather conditions as damage is likely to occur. If needed collapse extended pole and redeploy after weather has passed.**

**Additionally, ensure the assembly is stable. Very loose soil or mud will not support the light assembly and damage will occur.**

#### KIT CONTENTS:

- Case x1
- Light Assembly x1
- Wiring Harness x1
- Battery Adapter x1
- Remote x1



## INSTALLATION INSTRUCTONS

1. Locate each piece of the Tri Pod light from the carry tube. **See Photo 1.**
2. Remove the light from the case and put the harness and remote to the side.
3. Unfold the light panels. **See Photo 2.**

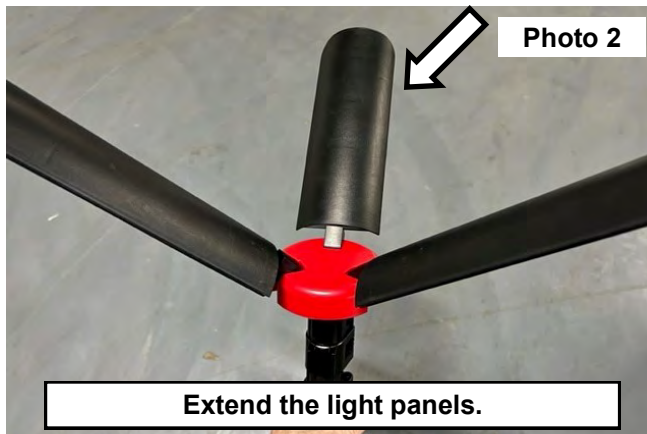

4. Release the tri pod legs by pulling the tab on the assembly. **See Photo 3.**
5. Extend the legs and lock them into place by pressing the tab as shown. **See Photo 4.**



6. Secure the assembly to the ground using the supplied metal stakes. **See Photo 5.**
7. Connect the supplied wiring harness to the bottom of the assembly as shown. **See Photo 6.**

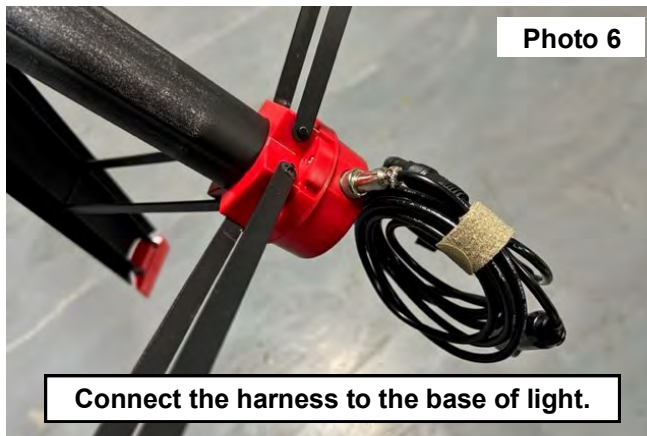



8. Extend the light by releasing the tabs and extend. Lock the tabs when the desired height is reached. **See Photo 7.**  
9. Connect the plug or clips to the harness, whichever is preferred. **See Photo 8.**

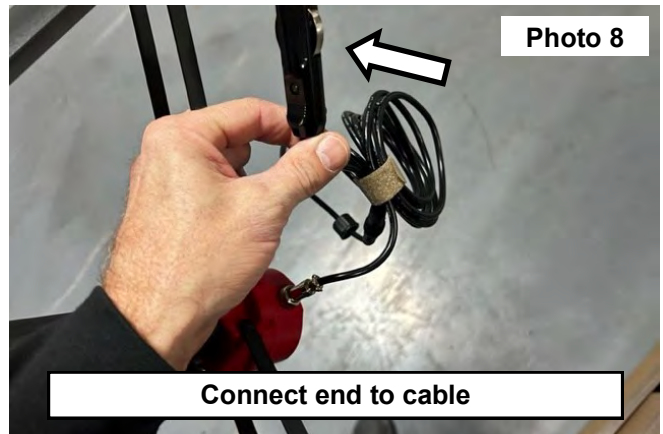
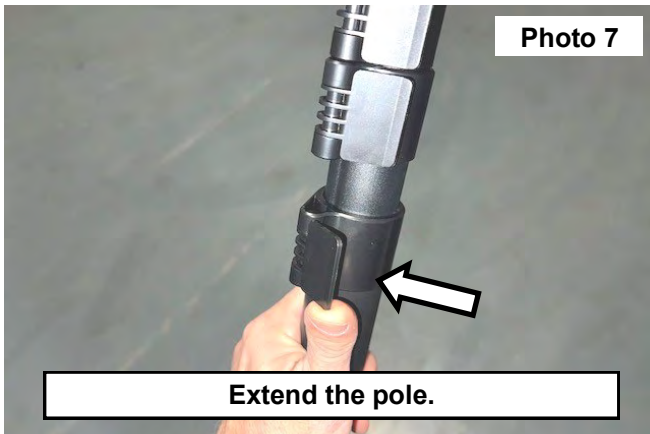

10. Connect to a 12 volt accessory port or to a 12volt battery using the supplied quick release clamps. **Photo 9 & 10**  
11. Use the supplied remote to turn the light on and use each function of the light.

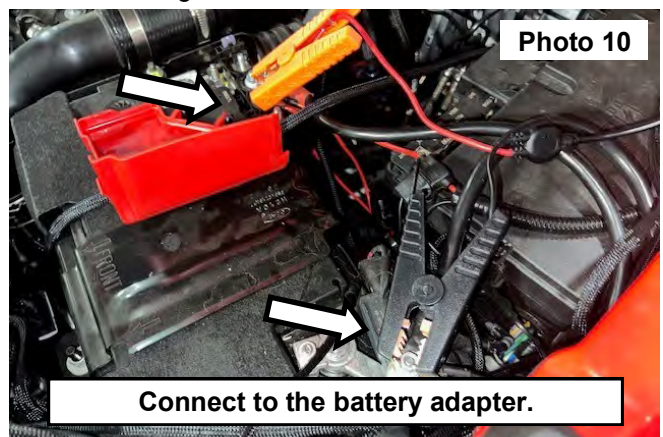
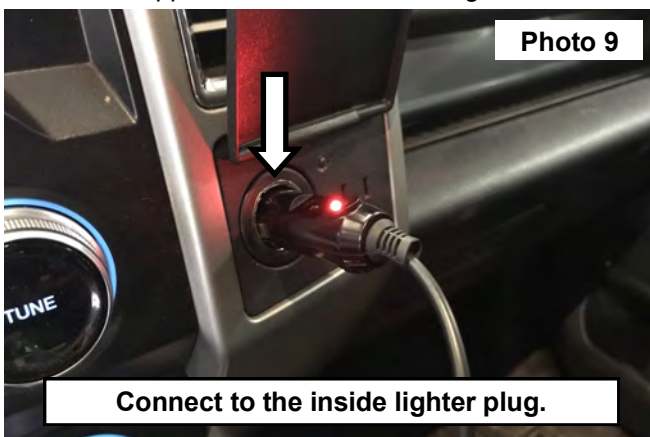

12. The remote can be stored on the light pole as shown. **See Photo 11.**



## Wireless Remote Functions

**1.Power On/Off:** Control the power of the remote control.  
Please turn it off when not in use.

**2.Turn On/Off;** Turn the light On or Off.

### 3.Brightness Adjustment

Speed " + " : Brightness up

Speed " - " : Brightness down

### 4.Light Heads

This switch controls the light heads work mode. Normally, 3 light boards work at the same time.If you need to switch,the light heads mode rotates in the following sequence by each press on the switch:one panel light head work - two panel light heads work - there panel light heads work.

### 5.Flash Mode



- **Power Supply.** This unit accepts a 12v power supply. The red cable should be connected to positive and black to negative. Please select proper power supply.
- **Remote Control.** The remote battery is 3v CR1632 type, please only replace with same type battery.

By purchasing any item sold by Rough Country, LLC, the buyer expressly warrants that he/she is in compliance with all applicable, State, and Local laws and regulations regarding the purchase, ownership, and use of the item. It shall be the buyers responsibility to comply with all Federal, State and Local laws governing the sales of any items listed, illustrated or sold. The buyer expressly agrees to indemnify and hold harmless Rough Country, LLC for all claims resulting directly or indirectly from the purchase, ownership, or use of the items.

