

### Square Awning

**Thank you for choosing Rough Country for all your vehicle needs.**

Please read instructions before beginning installation. Check the kit hardware against the kit contents shown below. Be sure you have all needed parts and know where they go.

If question exist, please call us @1-800-222-7023. We will be happy to answer any questions concerning this product.

Check all fasteners for proper torque. Check to ensure for adequate clearance between all components.

Periodically check all hardware for tightness.

**▲ NOTICE** This product is shown installing with the Rough Country bed rack system. Other mounting may require additional hardware or mounts other than what is included.

**▲ NOTICE** If Rough Country bed rack is already installed, some disassembly is required.

**▲ NOTICE** If a tent is installed, the tent may need to move to passenger side for clearance.

**KIT CONTENTS:**  
 Rough Country Awning  
 Mounting Brackets/Plates x2  
 Stakes x2  
 Rope Line x2

**Hardware Included:**  
 8mm x 20mm Bolt x4  
 8mm x 55mm Bolt x4  
 8mm Lock Nuts x8

**TOOLS REQUIRED:**  
 10mm Wrench (included)  
 13mm Wrench (included)



**Torque Specs:**

Size	Grade 5	Grade 8	Size	Class 8.8	Class 10.9
5/16"	15 ft/lbs	20ft/lbs	6MM	5ft/lbs	9ft/lbs
3/8"	30 ft/lbs	35ft/lbs	8MM	18ft/lbs	23ft/lbs
7/16"	45 ft/lbs	60ft/lbs	10MM	32ft/lbs	45ft/lbs
1/2"	65 ft/lbs	90ft/lbs	12MM	55ft/lbs	75ft/lbs
9/16"	95 ft/lbs	130ft/lbs	14MM	85ft/lbs	120ft/lbs
5/8"	135ft/lbs	175ft/lbs	16MM	130ft/lbs	165ft/lbs
3/4"	185ft/lbs	280ft/lbs	18MM	170ft/lbs	240ft/lbs



## INSTALLATION INSTRUCTIONS

1. If Rough Country bed rack is already installed, remove the two bolts securing the cross member to the driver side corner pieces. Retain hardware for reuse. Remove plastic end cap. **See Photo 1.**
2. Place bracket on driver side corner piece and align the slots with the four holes. Use the 8mm hardware from the bed rack kit to secure the inner bracket slot. Tighten with a 5mm Allen wrench. **See Photo 2.**

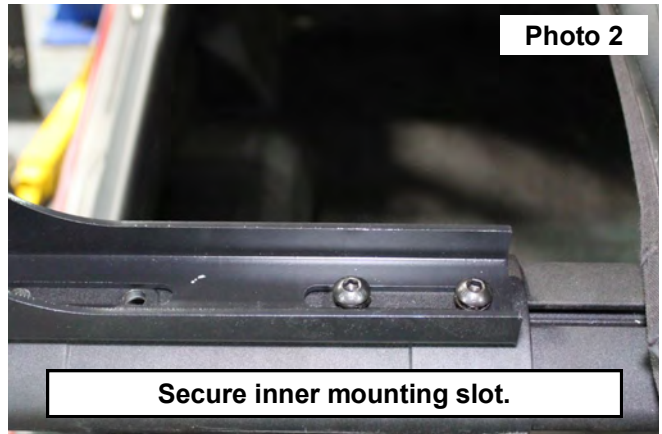
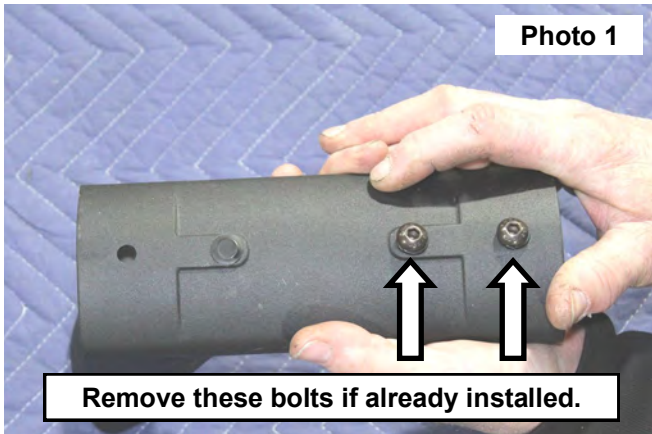

3. Use two (2) of the supplied 8mm black oxide bolts, flat washers, lock washers, and lock nuts to secure the outer bracket slot to the corner piece. Tighten with a 13mm wrench and 5mm Allen wrench. **See Photo 3.**
4. Repeat for other bracket/corner piece on the driver side.
5. Reinstall plastic cover caps. **See Photo 4.**

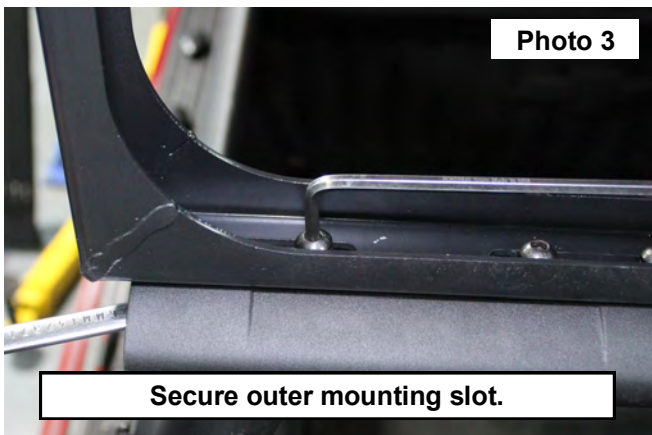

6. Slide eight (4) 8mm x 20mm stainless bolts into the track of the awning. Two bolts will go in each track on each end. **See Photo 5.**
7. Align the bolts with the holes of the awning brackets and secure with the supplied 8mm stainless lock nuts. Slide the awning towards or away from cab as needed to get proper fitment. Tighten with a 13mm wrench. **See Photo 6.** Awning brackets shown off of vehicle to show mounting.

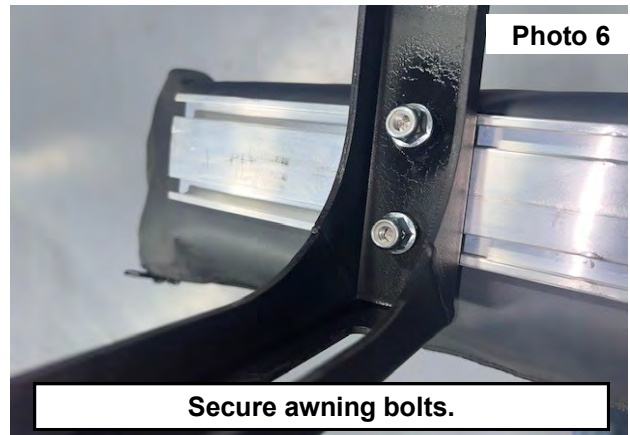
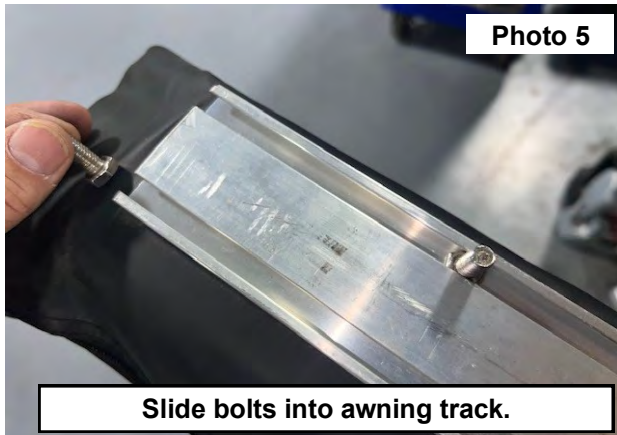

## AWNING SETUP

1. Unzip the awning bag and fold bag over the top. Release the Velcro straps. **See Photo 1 & 2**



2. Unroll the awning. **See Photo 3.**
3. It is helpful to have two persons help with this step. Unfold the horizontal prop rods and vertical prop rods and insert into the frame. **See Photo 4 & 5.**



4. Secure the top to the prop rods using the Velcro on the awning. **See Photo 6.**



5. Prop rod shown installed in **Photo 7**.
6. Install the supplied tie down rope in the frame. **See Photo 8**.

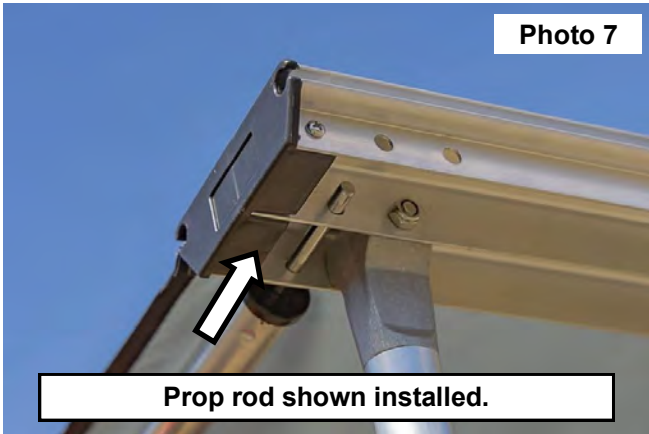

7. Install supplied stake in stable ground and attach the tie down rope to the ground stake. The optimum angle would be approximately 45 degrees from the awning to keep the awning tight. As with any awning, monitoring wind and weather conditions is required to ensure damage does not occur to the awning or vehicle. **See Photo 9**.
8. Tighten tie down rope to keep awning taut. **See Photo 10**.



9. Reverse the steps to collapse the awning.

By purchasing any item sold by Rough Country, LLC, the buyer expressly warrants that he/she is in compliance with all applicable, State, and Local laws and regulations regarding the purchase, ownership, and use of the item. It shall be the buyers responsibility to comply with all Federal, State and Local laws governing the sales of any items listed, illustrated or sold. The buyer expressly agrees to indemnify and hold harmless Rough Country, LLC for all claims resulting directly or indirectly from the purchase, ownership, or use of the items.

